



LIECHTENSTEIN



Facts and Figures 2015

Liechtenstein





Contents

- Geography and climate
- History, constitution and population
- Economy, employment and income
- Agriculture, industry and services
- Transport, energy and public finance



Geographical situation



Location and area

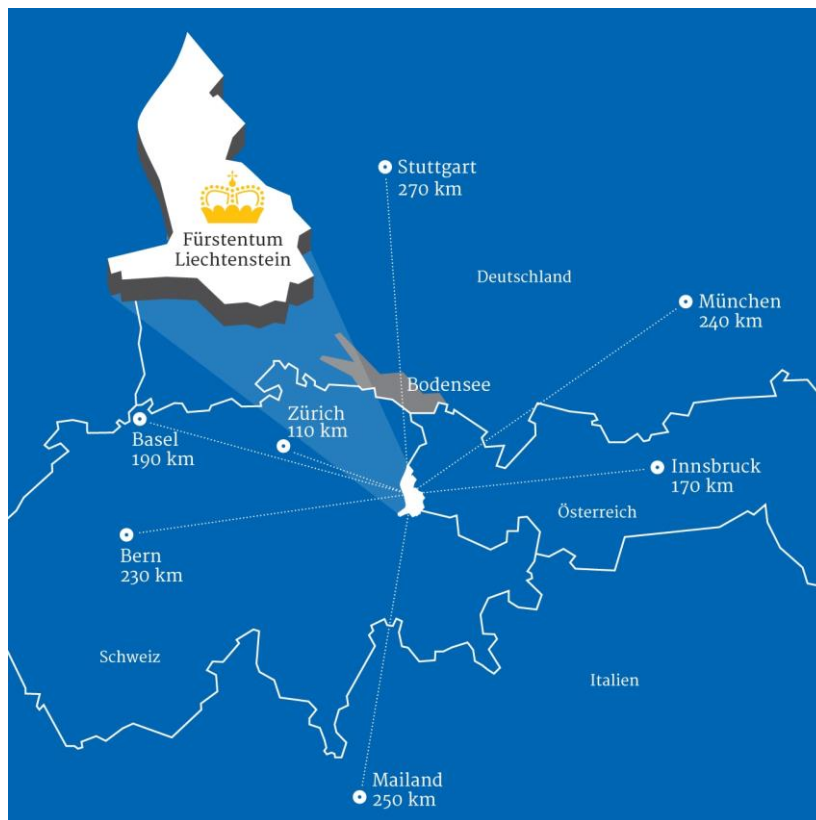

Total area	160 km ²
Wooded area	66 km ²
Agricultural area	53 km ²
Unproductive area	24 km ²
Settlement area	17 km ²

Source: Office of Statistics



Facts and figures

- _ Liechtenstein is the sixth smallest country in the world
- _ Liechtenstein is 24.8 km long and a maximum of 12.4 km wide
- _ Highest mountain: Grauspitz (2'599 metres)
- _ Lowest point: Ruggeller Riet (430 metres)
- _ Frontiers: 41.2 km with Switzerland; 36.7 km with Austria

Source: Office of Statistics



Climate



Climate



- Mild, despite mountainous location
- Strongly influenced by the föhn (a warm, dry katabatic wind)
- 900 to 1'200 mm (1'900 mm in Alpine region) precipitation per year
- Temperatures: -10 to 28°C

Source: Office of Statistics

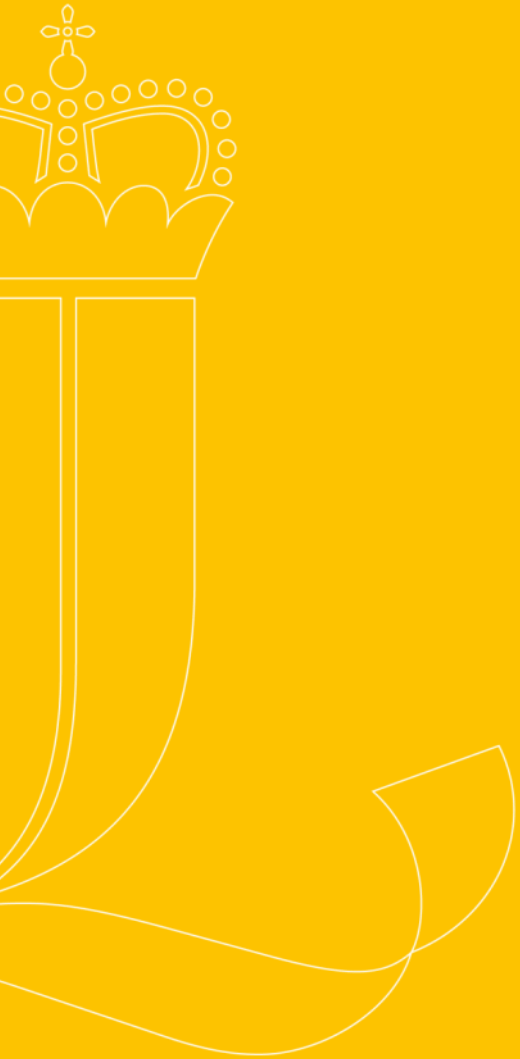

History and constitution



From foundation to sovereignty

- 1342 Foundation of the earldom of Vaduz
- 1699, 1712 Prince Johann Adam Andreas (Hans Adam I.) purchases the domain of Schellenberg and the earldom of Vaduz
- 1719 Vaduz and Schellenberg become the Imperial Principality of Liechtenstein
- 1806 Inclusion in the Confederation of the Rhine: Liechtenstein becomes a sovereign state

Source: Office of Statistics



Constitution, treaties, memberships



- 1862 New constitution, parliament created to represent the people
- 1924 Customs Treaty with Switzerland, Swiss franc introduced as official currency
- 1990 160th UN member state
- 1991 Member of the EFTA
- 1995 Accession to the EEA and WTO

Source: Office of Statistics



State information

— **Form of state**

Constitutional hereditary monarchy on a democratic and parliamentary basis

— **Head of state**

His Serene Highness Prince Hans-Adam II von und zu Liechtenstein; on 15 August 2004, Prince Hans-Adam II entrusted Hereditary Prince Alois to exercise his sovereign powers as his representative

— **Government**

Five-member government nominated by parliament and appointed by the Prince for four years

Source: Office of Statistics



Politics

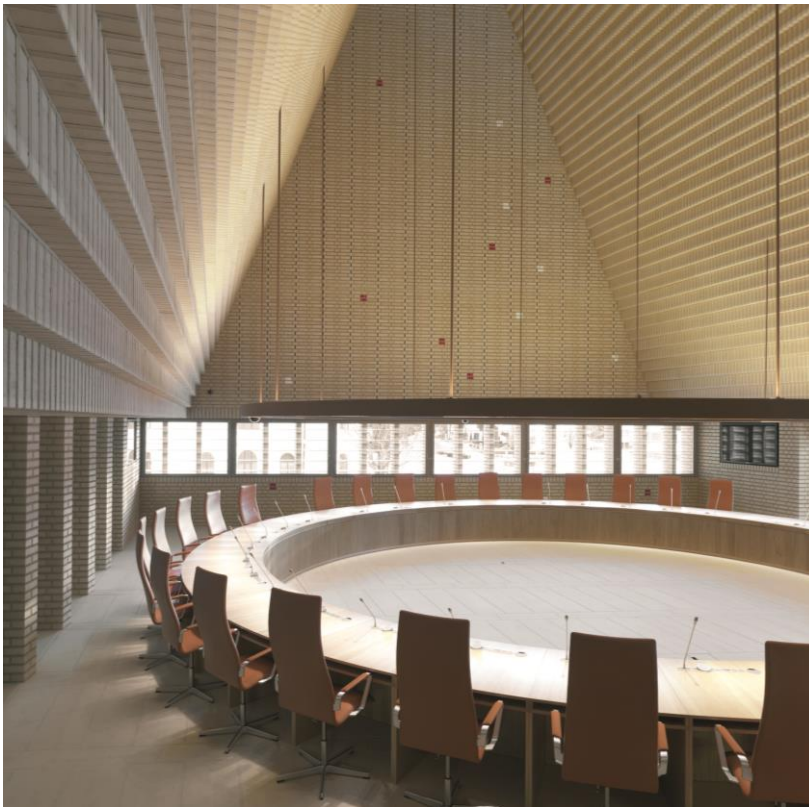

- **Parliament**
25 members elected by the people for four years
- **Political parties**
Progressive Citizens' Party
Patriotic Union
The Independents
Free List

Source: Office of Statistics



Courts

— Civil and criminal cases

- First instance: Landgericht
- Second instance: Obergericht
- Third and final instance: Oberster Gerichtshof

— Public law

- Administrative Court
- Staatsgerichtshof

Source: Office of Statistics



Population



Population 2013

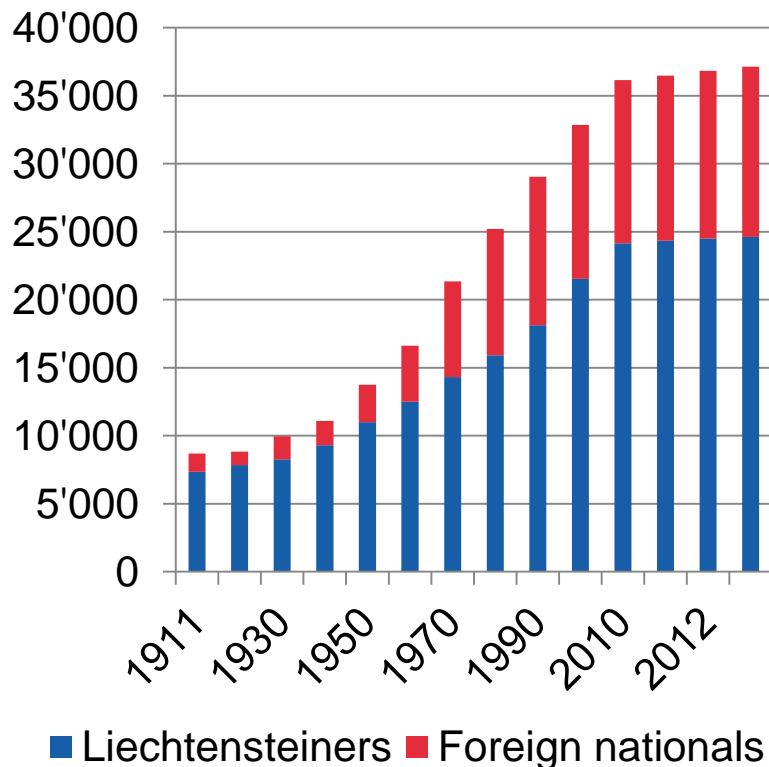

- Around 37'129 inhabitants
- 11 municipalities, largest municipality is Schaan (5'925 inhabitants)
- Capital is Vaduz with 5'372 inhabitants
- One third of the population are foreign nationals (mainly from Switzerland, Germany, Austria and Italy)

Source: Office of Statistics



Economy



Economy

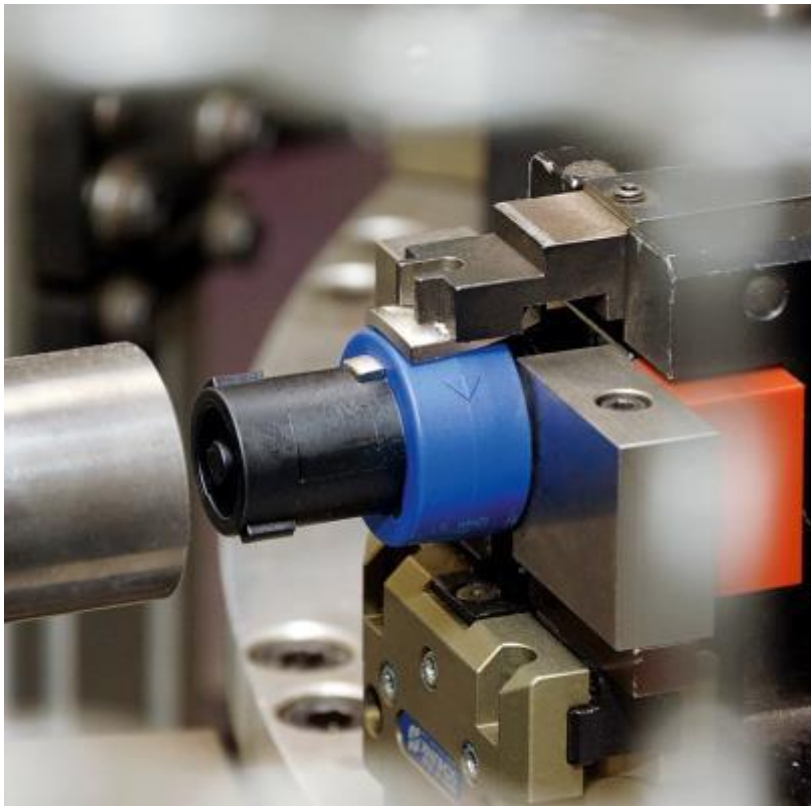

- _ Highly diversified economy
- _ Numerous small and medium-sized enterprises
- _ Strong industrial sector and financial services
- _ Swiss franc (CHF) has been the official currency since 26 May 1924

Source: Office of Statistics



Gross domestic product (GDP)

in bn CHF

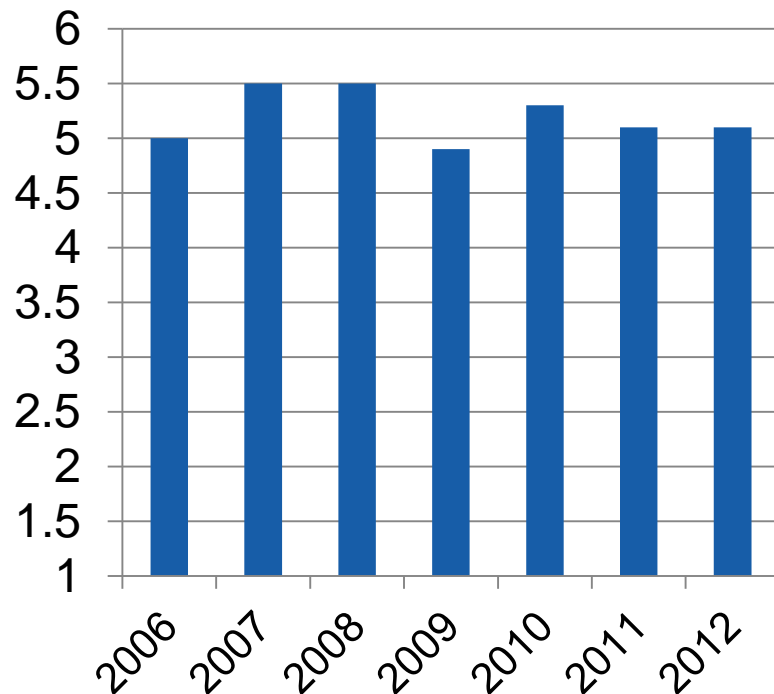

- Comparisons with other countries based on GDP per inhabitant yield misleading results since a large proportion of the working population commutes to Liechtenstein from surrounding countries
- GDP per working person is an appropriate basis for comparisons

Source: Office of Statistics



Gross value added in 2012

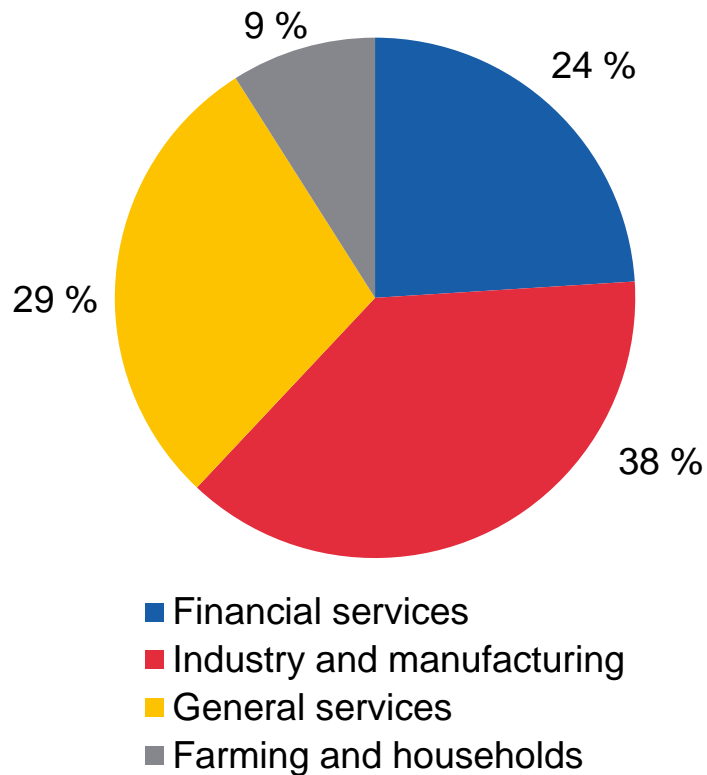

- Strong financial sector and services sector (together 55 %)
- Industry and goods production account for around 40 % of gross value added

Source: Office of Statistics



Number of enterprises by sector in 2013

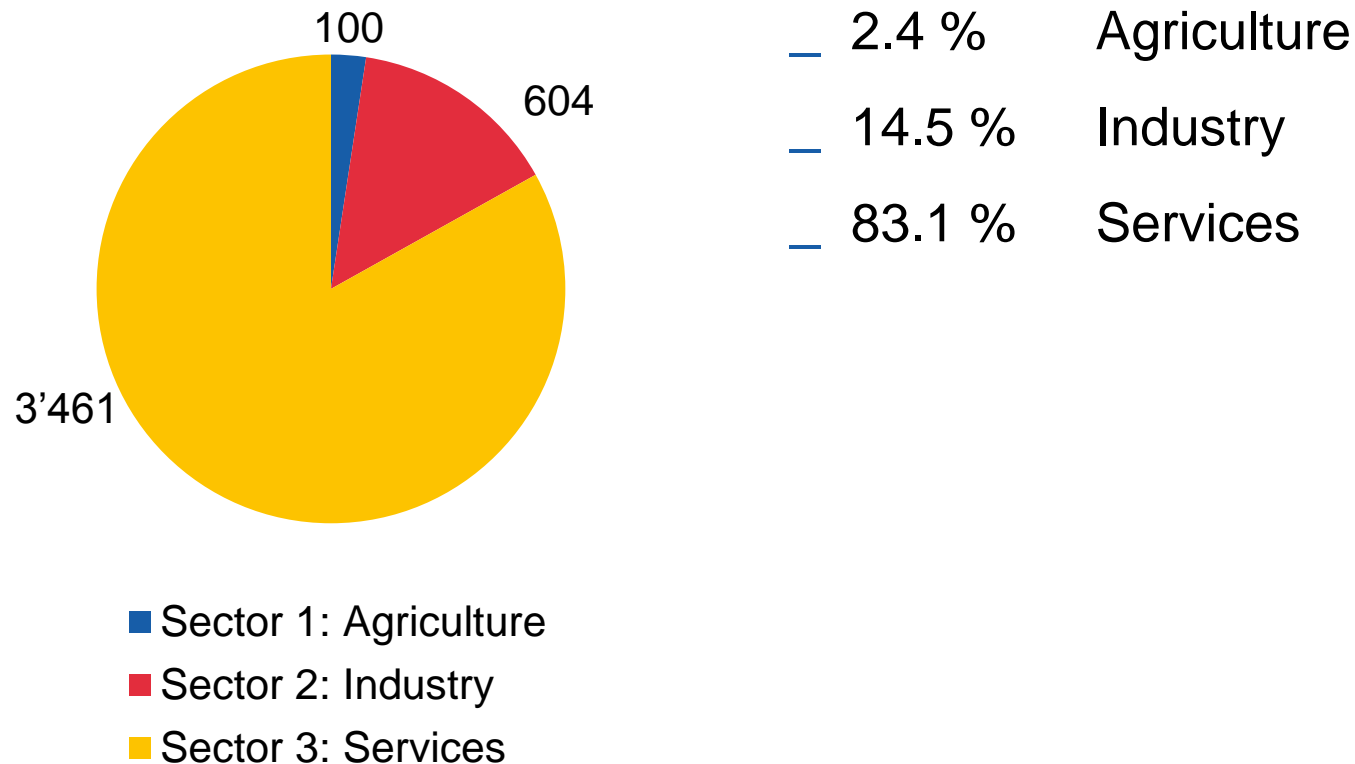

Source: Office of Statistics

Number of enterprises by size in 2013

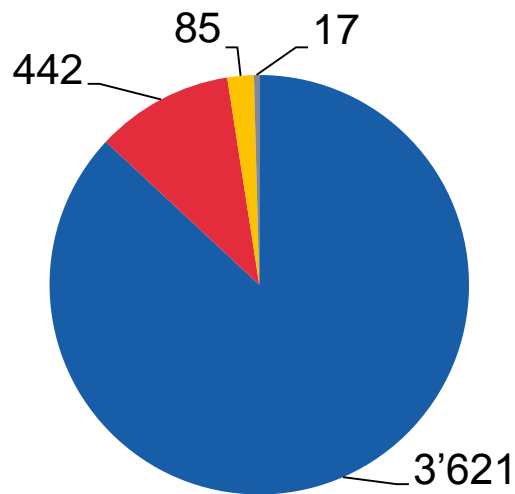

- 1-9 employees
- 10-49 employees
- 50-249 employees
- 250 or more employees

- 86.9 % micro-enterprises
- 10.6 % small enterprises
- 2.1 % medium-sized enterprises
- 0.4 % large enterprises

Source: Office of Statistics

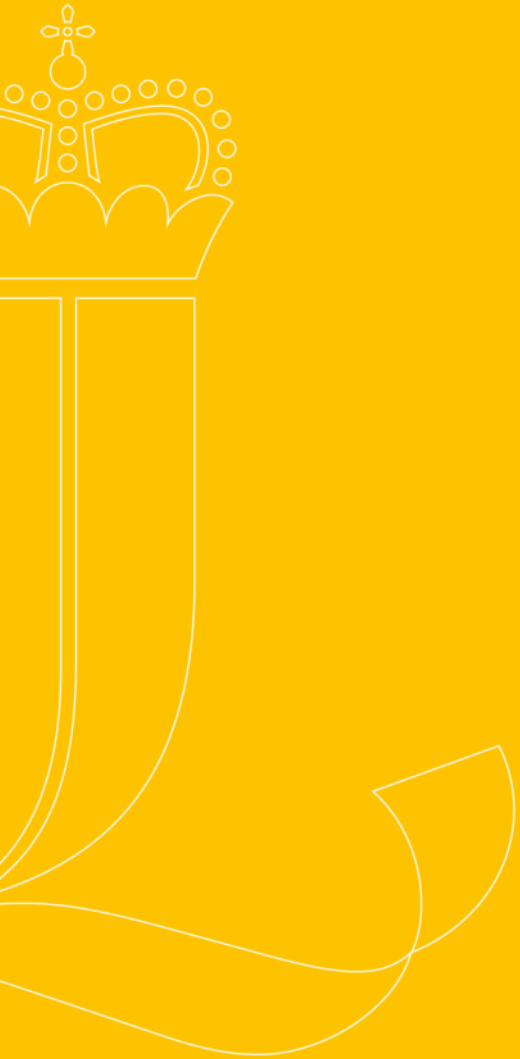

Employment and income



Working population in 2013

Type of worker	Number
Resident population in employment	18'994
Outward commuters	1'910
Inward commuters	19'140
Total employed	36'224
Of which foreign nationals (living in Liechtenstein or abroad)	24'921

- Strong growth in recent decades
- Small size of country requires input of labour from neighbouring countries
- Around half of the people employed in Liechtenstein do not live there

Source: Office of Statistics



Proportion of inward commuters in 2013

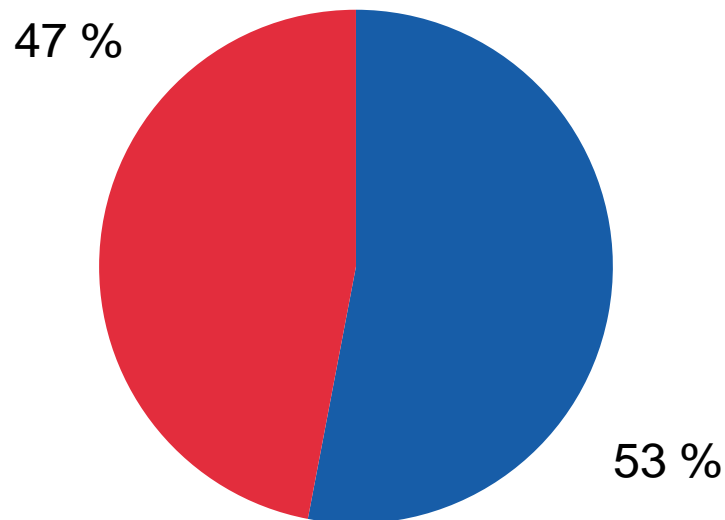

- Inward commuters
- Liechtenstein residents

— In 2013, 19'140 workers commuted to Liechtenstein from other countries

Source: Office of Statistics



Inward commuters by residence in 2013

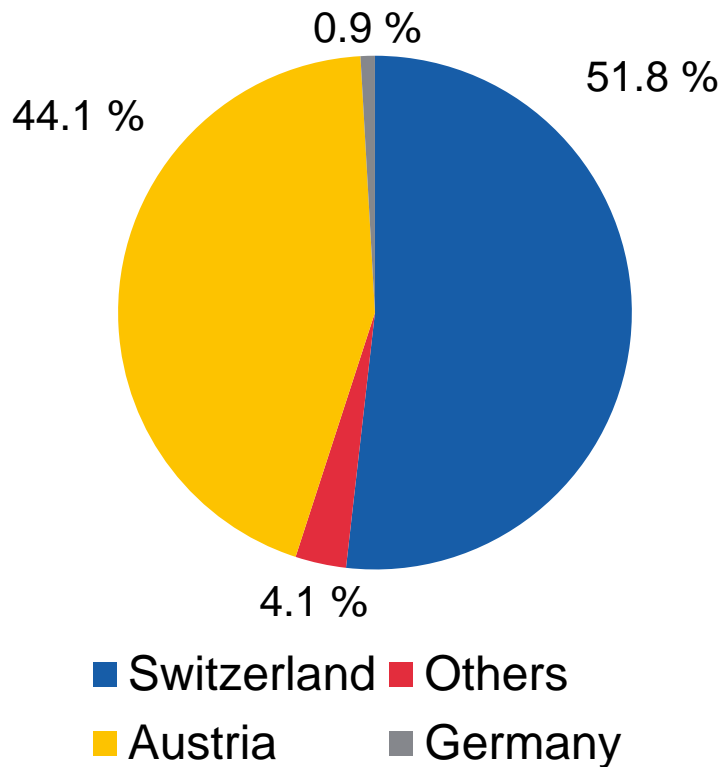

- More than half of inward commuters live in Switzerland
- 43 % of inward commuters live in Austria

Source: Office of Statistics



Proportion of foreign nationals in workforce in 2013

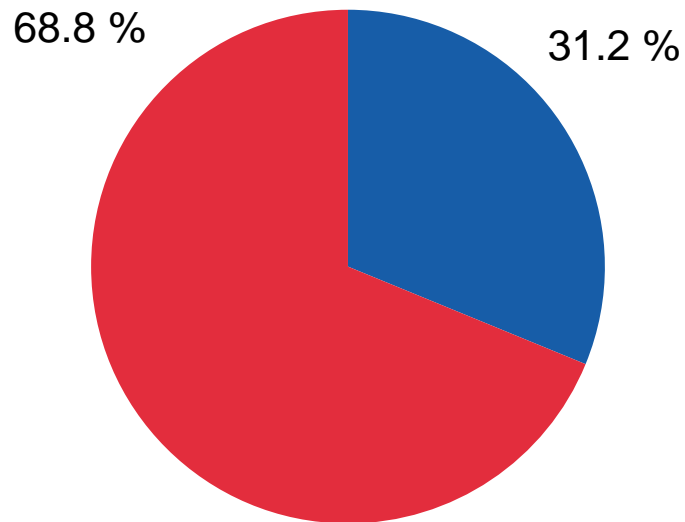

■ Liechtensteiners
■ Foreign nationals

- More than two-thirds of jobs in Liechtenstein are performed by foreign nationals

Source: Office of Statistics

Employment by economic sector, 2013

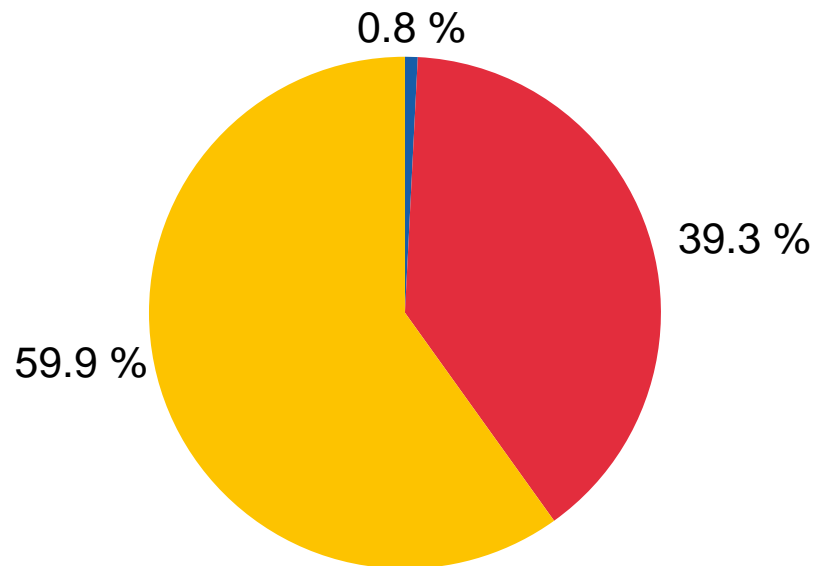

- Sector 1: Agriculture
- Sector 2: Industry
- Sector 3: Services

- 275 people worked in agriculture
- 14,248 people worked in industry
- 21,701 people worked in the services sector

Source: Office of Statistics



Unemployment rate at end of year

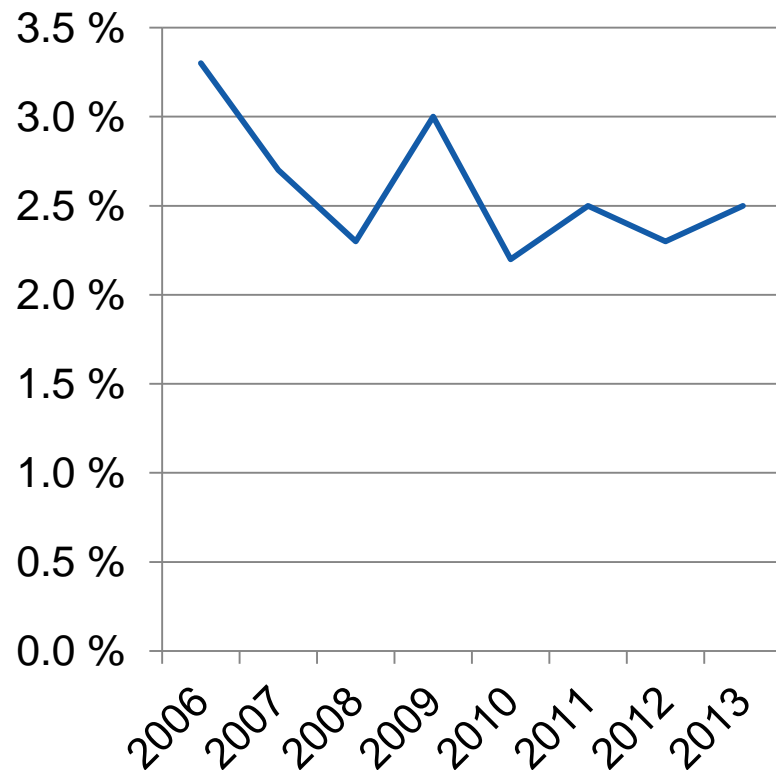

- Since 2006 the unemployment rate has fluctuated at a low level (2.2 % to 3.3 %)

Source: Office of Statistics

Unemployment statistics

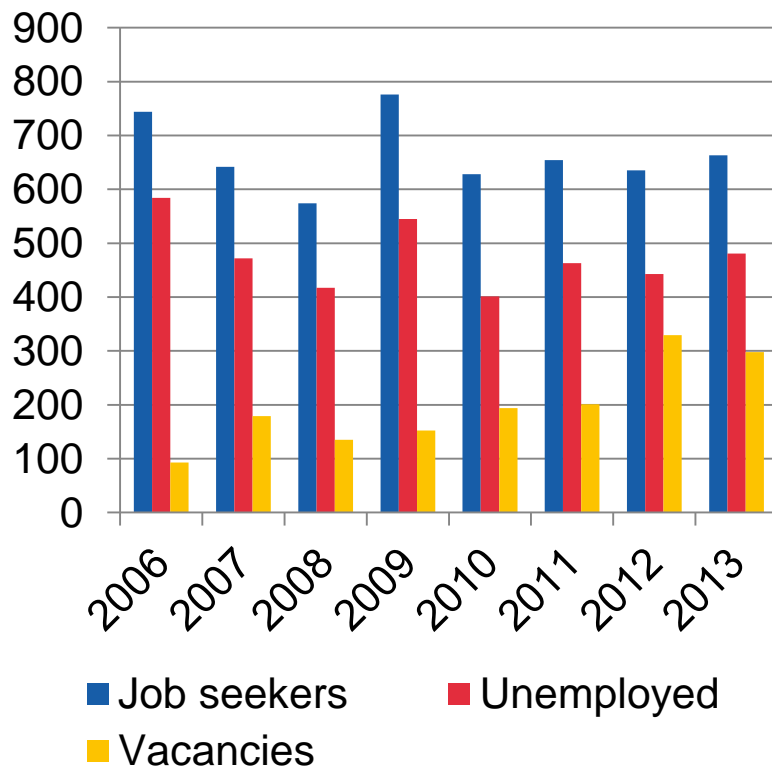

- Unemployed persons are defined as those who are registered at the Office for Economic Affairs, without work and able to take up employment immediately
- Job seekers are defined as all unemployed persons as well as persons who are registered at the Office for Economic Affairs but are not yet unemployed

Source: Office of Statistics



Agriculture

Agriculture



- Agricultural land accounts for 22 % (without Alps) of the total area
- About 60 dairy farms produce 14 million kg of milk each year
- About a third of the 109 recognised farms produce according to organic labels

Source: Office of Statistics



Farms by size

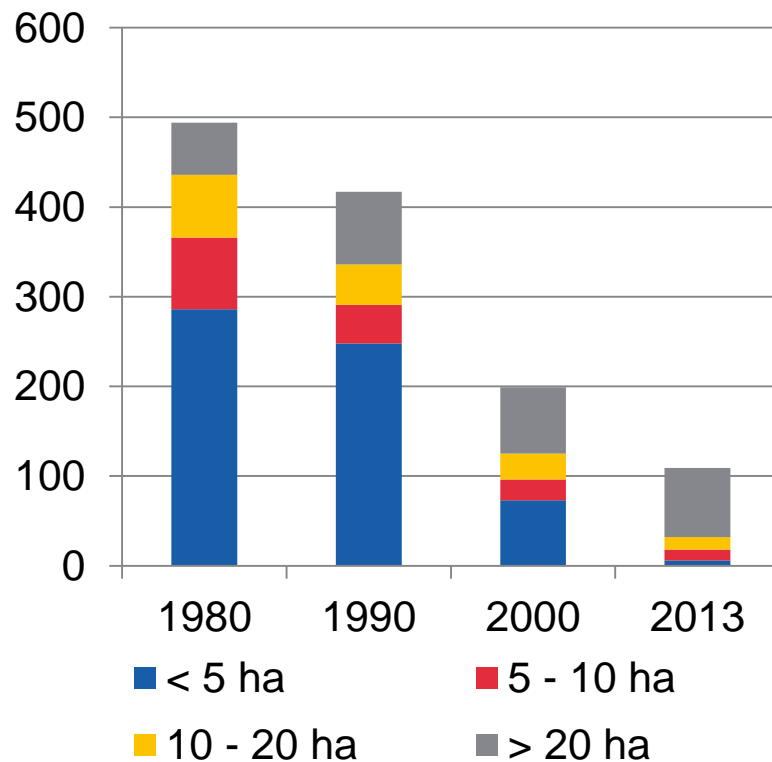

- Decrease since 1975
- Major reduction in number of small farms (< 5 ha), increase in number of large farms (>20 ha)
- Largest decrease between 1990 and 2000

Source: Office of Statistics



Industry



Industry

- _ Significant emphasis on industrial production
- _ 38 % of jobs provided by 615 industrial enterprises
- _ Most important sectors: mechanical engineering, electrical machinery, dental technology, vehicle components, food products and construction work
- _ Heavily export-oriented (Switzerland, Germany, USA) due to small domestic market

Source: Office of Statistics



Direct exports and imports (in million CHF)

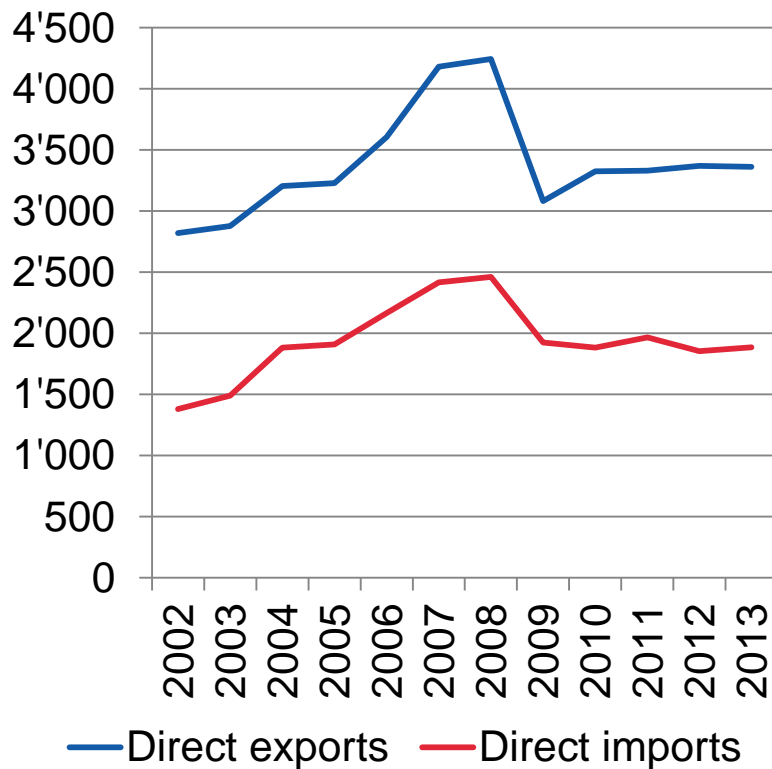

- Trade with Switzerland is not included in these figures
- Significant drop in 2009, followed by recovery in 2010 and 2011

Source: Office of Statistics



Services

Services

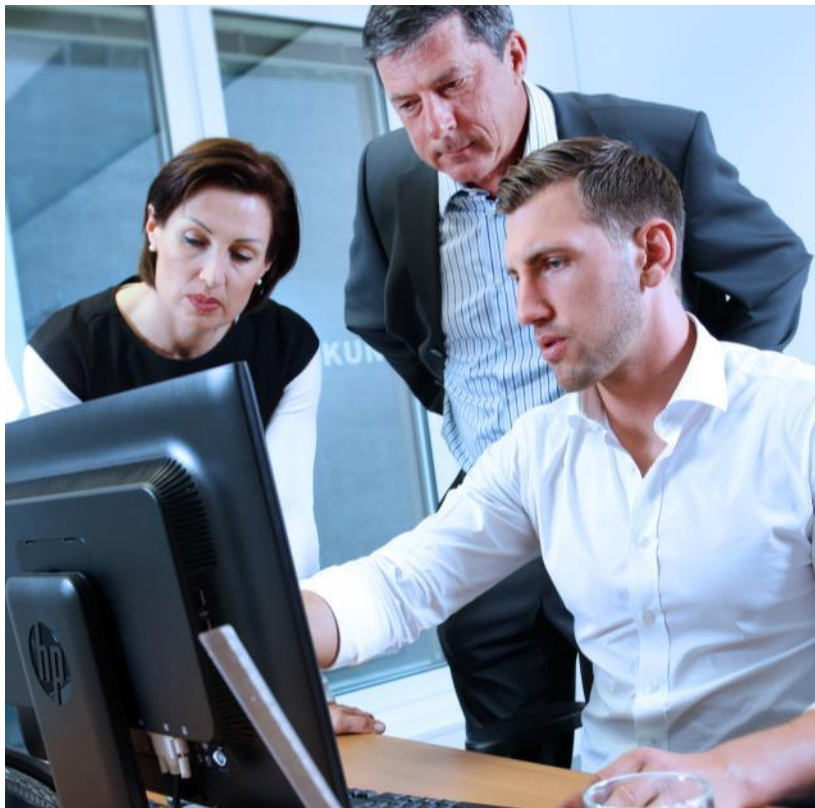

- _ Around 60 % of employees work in the services sector
- _ Important branches: financial and insurance services, legal and tax consultancy, trade

Source: Office of Statistics



Banks

in mn CHF	2000	2010	2011	2012	2013
Nominal balance	36'964	52'466	54'643	55'902	57'082
Net profit	549	570	163	260	471
Number of employees in Liechtenstein	1'773	2'117	2'109	2'059	2'049

Source: Office of Statistics



Domestic investment companies

in bn CHF	2009	2010	2011	2012	2013
Net assets	37.3	37.7	35.4	37.2	38.4
Individual portfolios	618	693	785	791	779
Investment companies	411	469	535	557	549

Source: Office of Statistics



Insurance companies

in bn CHF	2009	2010	2011	2012	2013
Gross premiums written	8.8	9.4	4.8	4.2	3.5
Investment assets	29.4	29.6	29.1	30.3	29.7
Technical provisions	26.6	28.8	28.3	29.1	28.7
Equity	0.8	0.8	0.7	0.8	1.0
Number of companies	41	40	40	40	42
Employees in Liechtenstein	357	370	377	365	337

Source: Office of Statistics



Tourism

	1970	1980	1990	2000	2010	2013
Number of businesses	70	64	60	49	40	36
Beds available	1'415	1'760	1'387	1'314	1'144	978
Guest arrivals	72'421	85'033	77'735	62'894	51'815	53'044
Overnight stays	145'247	182'443	149'861	133'485	115'051	133'197

Source: Office of Statistics



Transport



Motor vehicles (1 July 2014)

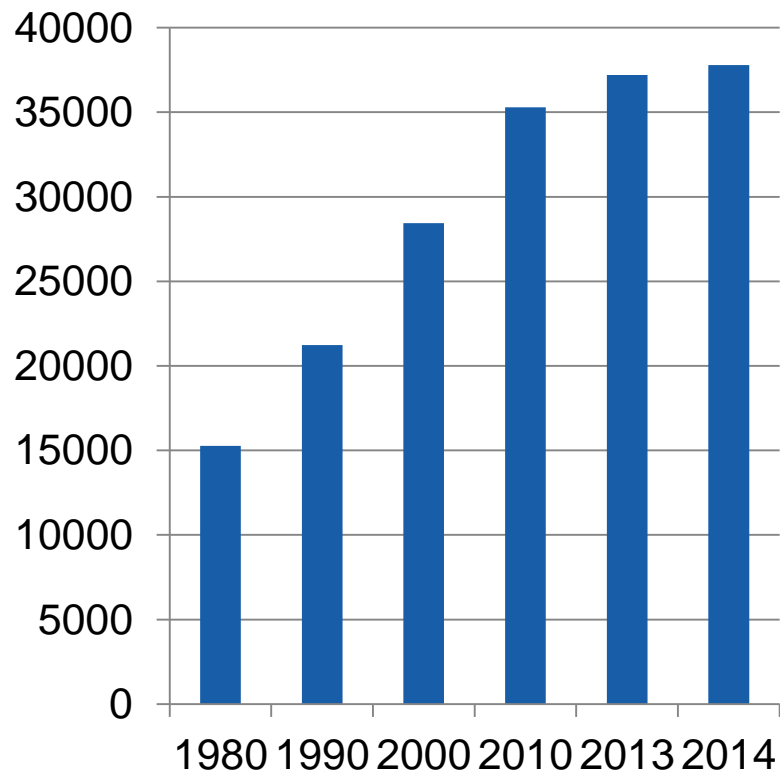

- 120 km of state roads and 260 km of local community roads
- 9 km railway line operated by the Austrian Federal Railways
- High level of motorisation: 770 passenger cars for every 1'000 inhabitants

Source: Office of Statistics



Energy



Energy supply



- Main sources of energy: natural gas, electricity, oil, petrol
- Proportion of own energy supply: 10 %
- Own energy supply from electricity, firewood, biogas
- Certification: all eleven municipalities have received the European Energy Award

Source: Office of Statistics



Public Finance



Public budgets

- _ State budget and local budgets of the eleven municipalities
- _ Tax revenue 2013: CHF 670 million
- _ Largest fields of expenditure for national budget: social welfare and education

Source: Office of Statistics



National budget: Overview

in mn CHF	2012	2013
Operating revenue	882	651
Operating expenditure	-896	-871
Operating result	-14	-220
Net financial result	105	134
Extraordinary result	-221	0
Result of the profit and loss account	-130	-86
Depreciation on fixed capital	45	43
Gross investment	-55	-39
Investment income	19	18
Financing surplus/deficit	-120	-65

Source: Office of Statistics



Municipal budgets: current accounts

in mn CHF	2000	2005	2010	2013
Current expenditure	139	145	179	187
Current revenue	288	267	314	227
Cash flow	149	122	135	89
Depreciation on fixed capital	65	73	94	72
Surplus current accounts	84	49	41	17

Source: Office of Statistics



Humanitarian cooperation and development

- Official development assistance (ODA) according to the OECD criteria for development cooperation and humanitarian aid
- ODA spending for 2013: CHF 25.2 million
- Total ODA spending for 2012 was 0.75 of gross national income (GNI)

Source: Office of Statistics



Disclaimer

Copyright

The presentations are protected by copyright owned by Liechtenstein Marketing (company registration number FL-0002.389.722-0) or third parties. Distributing, copying, changing or using the material contained in the presentations (or sections thereof) in printed or digital form beyond the boundaries of copyright law requires the prior written permission of the respective copyright holder. Distributing and copying the material contained in the presentations (or sections thereof) in printed or digital form within the boundaries of copyright law requires without exception the inclusion of the name of the copyright holder. The information published on this website is made available to the public. Downloading or copying content, images, photos or other files does not result in any transfer of copyright on the content in question. The names and logos used are registered brands and as such protected by copyright. Therefore, images, names and logos may not be used. Liechtenstein Marketing reserves all rights concerning the content of the presentations and the brochure on Liechtenstein's economy.

Limitation of liability for content belonging to Liechtenstein Marketing

Although Liechtenstein Marketing takes the greatest care to ensure the correctness of the information published, it and its contractual partners can accept no responsibility (including towards third parties) for the topicality, completeness, correctness and accuracy of the presentations and the brochure on Liechtenstein's economy. All liability claims are excluded against Liechtenstein Marketing concerning material or immaterial damage resulting from accessing, using or not using the information published, from misuse of the connection, and from technical malfunctions. This also applies to direct and indirect secondary damage.

Limitation of liability for external links

This presentation may contain external links (connections to websites owned by third parties). Liechtenstein Marketing and its contractual partners accept no responsibility for the topicality, completeness and correctness of the content on the websites linked to from this presentation. The respective owners of these websites are responsible for the content of the websites and its correctness. Liechtenstein Marketing accepts no responsibility for such websites.

Data protection

Accessing our website results in information about each visit (date, time, pages accessed) being saved on the server. This does not involve an analysis of personal data (e.g. name, postal address or e-mail address). Analysis of personal data is carried out – as far as possible – only after receiving prior permission from the website user. This data will not be passed on to third parties without the express permission of the user. We would like to emphasise that data transfer via the internet can be subject to security loopholes. It is not possible to provide absolute protection for data against access by third parties. We assume no liability for damage resulting from such security loopholes.



Liechtenstein Marketing

Äulestrasse 30

9490 Vaduz

+423 239 63 63

info@liechtenstein.li

www.liechtenstein.li